

ADDENDUM NO. 1



DATE ISSUED: December 03, 2018

PROJECT: R18-445 ELLISON COMMUNITY HALL STAIRS - FABRICATE & INSTALL

The Contract Documents for this work are revised as noted herein. All such revisions become a part of the work and shall be included in your proposal. No consideration will be allowed for extras due to the contractor not being familiar with this addendum.

1. REFERENCE: Closing Date and Time

The Closing Date and Time for this RFP is hereby extended by one week. All references to the “Closing Date and Time” are amended as follows:

DELETE: December 10th, 2018 at 3:00PM Local Time

REPLACE WITH: December 17th, 2018 at 3:00PM Local Time

2. REFERENCE: Answers to Questions Received

The following are answers to questions received:

Q1	Will the Building Permit be paid for directly by the Owner?
A1	Yes, the Regional District of Central Okanagan will directly pay for the Building Permit.

Q2	Will power be available on Site at no cost to the Bidder?
A2	On site power can be used at no cost to Contractor.

Q3	Will water be available on Site at no cost to the Bidder?
A3	On site water can be used at no cost to Contractor.

Q4	Is cast-in place an acceptable alternative to pre-cast for the stairs?
A4	We are looking for Pre-cast in this proposal in an effort to shorten the downtime of the community center’s entrance.

3. REFERENCE: Clarifications from Proponent Meeting

The following are key points made during the Proponent’s Meeting:

- The contractor will be responsible for Geotech and soil testing.
- The RDCO is looking for Pre-cast Concrete for this project in an effort to reduce the amount of time the front entrance is out of use by the public.

- After structural review of the plan, the location of steel supports is sufficient to support the overhang and the point loading will not be an issue.
- Contractor is responsible to confirm dimensions to ensure site fit.
- Broom finish to be provided to allow for non-slip surface.
- The overall dimensions and weight of precast is within shipping limits so we expect the stairs to be in one piece but this will need to be confirmed with the supplier.
- On site electricity and water is available for use by the contractor during construction.
- Provided is a plan view of existing stairs with additional existing footing details for information. Please note that drawings are provided as an attachment to this Addendum 1 and are provided for reference only and will not form part of the contract documents.
- Access to both main floor man doors located north and south of the stairs must be maintained during construction. Alternative routes can be provided across the lawn however these routes must be usable by persons with mobility issues.
- This is a request for proposal and not MMCD.
- All works to the building and the façade to accommodate for the additional width of stairs shall be included in the contract.
- Footings for steel supports may be poured in a single pour.
- Elemental Structural Engineering will perform inspection on RDCO's behalf

END OF ADDENDUM NO. 1

Please note that additional answers to questions and other clarifications will be provided in Addendum 2 (which we anticipate will be issued in a few days).

HSS 3.0
x.188

14'-6"

METAL PAN
STAIRS, TYP.

4" CONC. TOPPING
R/W 6x6 MESH ON
1.5"x22GA. METAL DECK
C/W L4x4x1/4 EDGE
ANGLES, TYP.

67'-0"

13'-4"

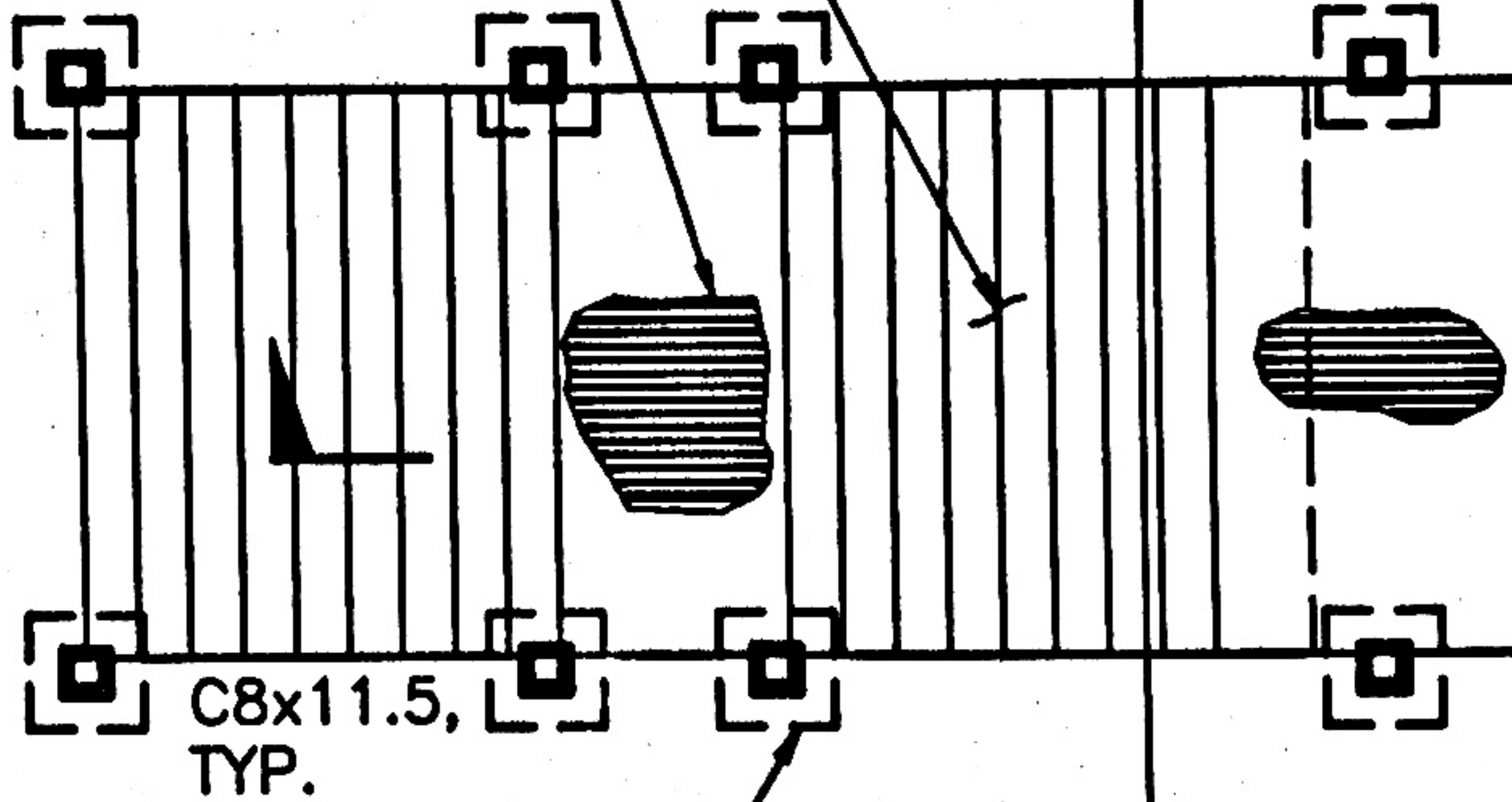

11'-1"

2'-0"x2'-0"x10"
PAD FOOTING R/W
3 - 15M E.W.,
C/W 10"Ø CONC.
PEDESTAL R/W
1 - 15M

5'-7"

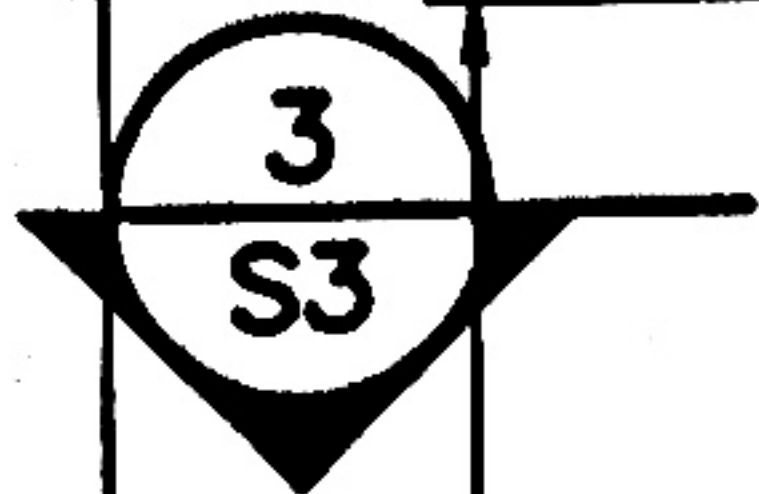

22'-6"

2