

REGIONAL DISTRICT OF CENTRAL OKANAGAN

BY-LAW NO. 305

Being a by-law to authorize the Extention of a Specified Area within Electoral Area 'I' of the Regional District of Central Okanagan

WHEREAS by By-law No. 140, the Joe Rich Fire Protection Specified Area was established to provide Fire Protection to the said Specified Area and amended by By-law No. 230, 271, and 291, the Joe Rich Fire Protection Specified Area Boundary Extension By-law;

AND WHEREAS the Regional Board of the Regional District of Central Okanagan deems it necessary to extend the boundaries of the said Specified Area;

NOW THEREFORE THE REGIONAL BOARD OF THE REGIONAL DISTRICT OF CENTRAL OKANAGAN IN OPEN MEETING ASSEMBLED, ENACTS AS FOLLOWS:

1. The boundaries of the Specified Area of Electoral Area 'I' defined by By-law No. 291 being the "Joe Rich Fire Protection Specified Area Boundary Extension By-law No. 291, 1986" is hereby extended to include the lands more particularly described in Schedule "A" attached hereto being Lot 17 Pl 31553 O.D.Y.D.
2. Schedule "B" of By-law No. 291 is hereby deleted and Schedule "B" attached hereto is substituted therefore.
3. This By-law may be cited as the "Joe Rich Fire Protection Specified Area Boundary Extension By-law No. 305, 1986."

READ A FIRST TIME THIS 5th DAY OF MAY, 1986
READ A SECOND TIME THIS 5th DAY OF MAY, 1986
READ A THIRD TIME THIS 5th DAY OF MAY, 1986

Received the approval of the Inspector of Municipalities on the
13th day of June, 1986.

Assented to by sufficient petition by the owners of Lot 17, Plan
31553, O.D.Y.D. this 14th day of April, 1986.

RECONSIDERED, FINALLY PASSED AND ADOPTED THIS 14th DAY OF
July, 1986.

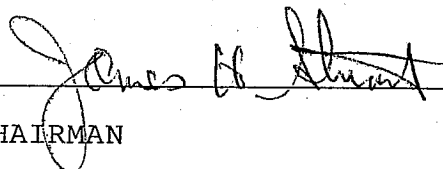

CHAIRMAN



SECRETARY

I hereby certify the foregoing to be a true and correct copy of
By-law No. 305, 1986 which was read a third time by the Regional
Board at its meeting held the 5th day of May, 1986.

Dated at Kelowna, B.C. this 13th day of May, 1986.

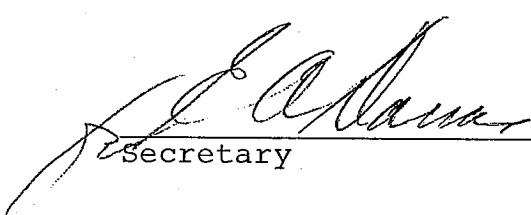

I hereby certify the foregoing to be a true and correct copy of
By-law No. 305, 1986 which was reconsidered and adopted by the
Regional Board at its meeting held the 14th day of July, 1986.

Dated at Kelowna, B.C. this 17th day of July, 1986.



Secretary

SCHEDULE "A"
Regional District of Central
Okanagan - Bylaw No. 305

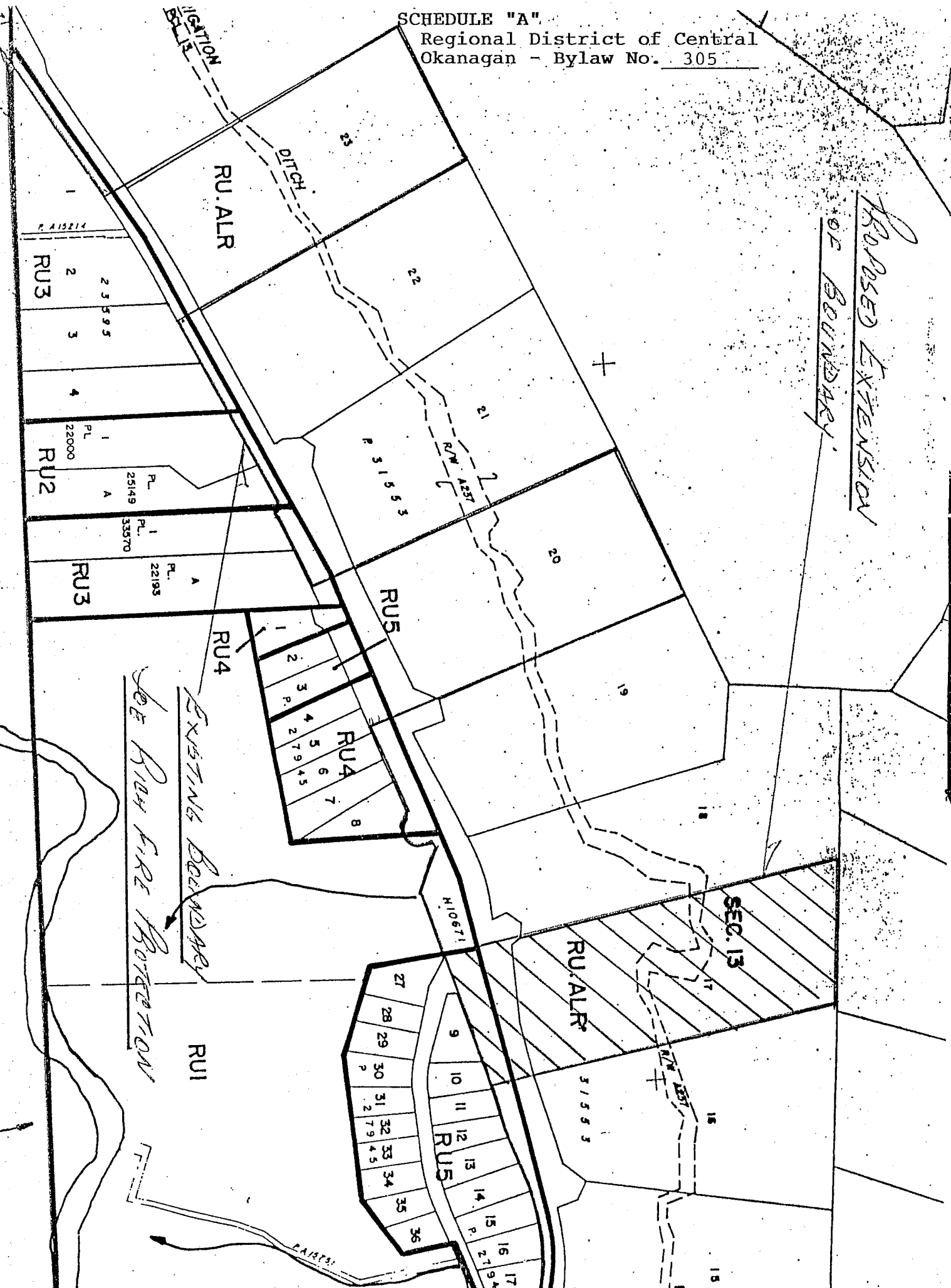

*PROPOSED EXTENSION
OF BOUNDARY*

EXISTING BOUNDARY

SEE FIRE PROTECTION

SEC. 13

RU.ALR

RU5

RU1

RU.ALR

RU5

RU4

RU3

RU2

RU3

RU4

1

2

3

4

1

2

3

4

5

6

7

8

9

10

11

12

13

14

15

16

17

18

19

20

21

22

23

24

25

26

27

28

29

30

31

32

33

34

35

36

P. A15214

23595

PL 22000

PL 25149

PL 33570

PL 22193

H10671

PL 21577

Schedule "B"

By-law No. 305

Regional District of Central Okanagan

Commencing at the northwest corner of Lot 4853, Osoyoos Division Yale District; thence easterly, southerly and westerly along the northerly, easterly and southerly boundaries of said Lot 4853 to the southwest corner thereof; thence southerly and westerly along the easterly and southerly boundaries of Lot 4504 to the southwest corner thereof; thence southerly along the easterly boundary of Lot 1306 to the northwest corner of Lot 1896; thence easterly, southerly and southwesterly along the northerly, easterly and southeasterly boundaries of said Lot 1896 to the most southerly corner thereof; thence southerly along the easterly boundary of Lot 4053 to the southeast corner thereof; thence easterly, southerly and westerly along the northerly, easterly and southerly boundaries of Lot 4851 to the southwest corner thereof; thence southerly along the easterly boundary of Lot 4052 to the northwest corner of Lot 4050; thence easterly and southerly along the northerly and easterly boundaries of Lot 4050 to the northwest corner of Lot 4087; thence easterly along the northerly boundary of Lot 4087 to the northeast corner thereof; thence northerly and easterly along the westerly and northerly boundaries of Lot 4511 to the southwest corner of Lot 4510; thence northerly and easterly along the westerly and northerly boundaries of said Lot 4510 to the northeast corner thereof; thence easterly and southerly along the northerly and easterly boundaries of Lot 4509 to the northwest corner of Lot 3737; thence easterly along the northerly boundary of said Lot 3737 to the northeast corner thereof; thence northerly, easterly, northerly and easterly along the westerly, northerly, westerly and northerly boundaries of Lot 4849 to the northeast corner thereof; thence northerly, easterly, northerly, easterly, southerly, westerly, southerly and westerly along the boundaries of Lot 4850 to the southwest corner thereof; thence southerly, westerly, southerly, westerly and northerly along the easterly, southerly, easterly, southerly and westerly boundaries of Lot 4849 to the point of intersection with the middle line of Mission Creek; thence in a general southwesterly direction along said middle line to the point of intersection with the northerly prolongation of the easterly boundary of Lot 4512; thence southerly along said prolongation and continuing southerly along the easterly boundary of said Lot 4512 to the southeast corner thereof; thence westerly along the southerly boundary of Lot 4512 to the northeast corner of Lot 4086; thence southerly and westerly along the easterly and southerly boundaries of said Lot 4086 to the southwest corner thereof; thence southerly along the easterly boundaries of Lot 4084 and 3459 to the southeast corner of said Lot 3459; thence easterly and southerly along the northerly and easterly boundary of Lot 4088 to the southeast corner thereof; thence southerly along the easterly boundary of Lot 4180 to the northwest corner of Lot 4852; thence easterly along the northerly boundary of Lot 4852 to the northeast

corner thereof; thence northerly, easterly, southerly and westerly along the westerly, northerly, easterly and southerly boundaries of Lot 5128 to the northeast corner of Lot 778; thence southerly and westerly along the easterly and southerly boundaries of said Lot 778 to the southwest corner thereof; thence southerly, westerly, northerly, westerly, northerly, westerly, northerly, westerly, along the boundaries of Lot 4852 to the most westerly southwest corner thereof; thence westerly and northerly along the southerly and westerly boundaries of Lot 4180, 5135, 4088, 5110, 4182 and 5126, respectively, to the northwest corner of said Lot 5126; thence westerly along the southerly boundary of Lot 4085 to the southwest corner thereof; thence westerly and northerly along the southerly and westerly boundaries of Lot 4514 to the southeast corner of Lot 4604; thence westerly along the southerly boundaries of Lot 4604, 2182, 4091, 3906, 4048, 4049 and 4051 to the southwest corner of said Lot 4051; thence southerly and westerly along the easterly and southerly boundaries of Lot 3742 to the southwest corner thereof; thence westerly along the southerly boundaries of Section 13 and 14, Township 27 to the southwest corner of Lot 1 of Section 14, Township 27, Registered Plan 23595, on file in the Land Title Office, Kamloops, being a point on the southeasterly limit of Highway Number 33 as shown on Registered Plan H10671; thence in a general northeasterly direction along the northerly boundary of Lot 1 of Section 14, Township 27, Registered Plan 23595 to the point of intersection of the southeasterly limit of Highway Number 33 as shown on Registered Plan H10671 and a point which lies due south of the southwest corner of Lot 23 of Section 14, Township 27, Registered Plan 31553; thence northwesterly, northeasterly and southeasterly along the westerly, northerly and easterly boundaries of Lot 23 of Section 14, Township 27, Registered Plan 31553 to the southeast corner thereof; thence southerly to the point of intersection with the southerly limit of Highway Number 33 as shown on Registered Plan H10671 and a point on the northerly boundary of Lot 3 of Section 14, Township 27, Registered Plan 23595; thence in a general northeasterly and easterly direction along the southeasterly and southerly limits of said Highway Number 33 as shown on Plan H10671 to a point which lies due south of the southwest corner of Lot 20 of Section 14, Township 27, Registered Plan 31553, thence northwesterly,

northeasterly, and southeasterly along the westerly, northerly and easterly boundaries of said Lot 20, Plan 31553 to the southeast corner thereof; thence southerly to the point of intersection with the southerly limit of the Highway Number 33 as shown on Registered Plan H10671; thence in a general northeasterly and easterly direction along the southeasterly and southerly limits of said Highway Number 33 as shown on Plan H10671 to a point which lies due south of the southwest corner of Lot 17 of Section 14 Township 27, Registered Plan 31553, thence northwesterly, northeasterly, and southeasterly along the westerly, northerly and easterly boundaries of said Lot 17, Plan 31553 to the southeast corner thereof; thence southerly to the point of intersection with the southerly limit of the Highway Number 33 as shown on registered Plan H10671; thence in a general northeasterly and easterly direction along the southeasterly and southerly limits of said Highway Number 33 as shown on Plan H10671 to a point which lies due south of the southwest corner of Lot A of Section 13, Township 27, Registered Plan 22289; thence north to said southwest corner; thence northerly and easterly along the westerly and northerly boundaries of Lot A of Section 13, Township 27, Plan 22289 to the northeast corner thereof; thence northerly and easterly along the westerly and northerly boundaries of Lot B, Registered Plan 23539 to the northeast corner thereof; thence easterly along the northerly boundary of District Lot 4502 to the southwest corner of District Lot 4507, thence easterly along the southerly boundary of Lot 4507 to the southeast corner of said Lot 4507; thence easterly in a straight line to the northwest corner of Lot 4048; thence easterly along the northerly boundaries of Lot 4048, 3906 and 3902 to the northeast corner of said Lot 3902; thence northerly and easterly along the westerly and northerly boundaries of Lot 4052 to the northeast corner thereof; thence northerly along the westerly boundary of Lot 4851 to the northwest corner thereof; thence westerly and northerly along the southerly and westerly boundaries of Lot 4053 to the northwest corner thereof; thence northerly and easterly along the westerly and northerly boundaries of Lot 1306, 4503 and 4504 respectively, to the northeast corner of said Lot 4504 to the aforesaid northwest corner of Lot 4853 being the point of commencement.